

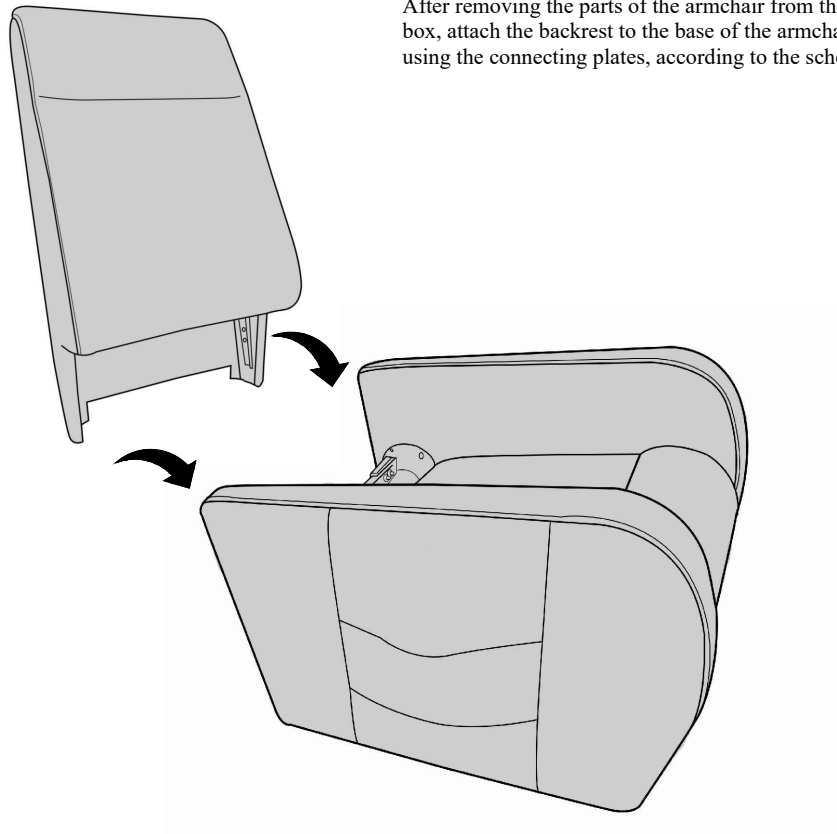

След като извадите частите на фотьойла от кашона, закачете облегалката към основата на фотьойла посредством плъзгащите планки, съгласно схемата.

Après avoir retiré les pièces du fauteuil de la boîte, fixez le dossier à la base du fauteuil à l'aide des plaques de connexion, conformément au schéma.

After removing the parts of the armchair from the box, attach the backrest to the base of the armchair using the connecting plates, according to the scheme.



Монтажна схема **Installation manual** **Notice de montage**

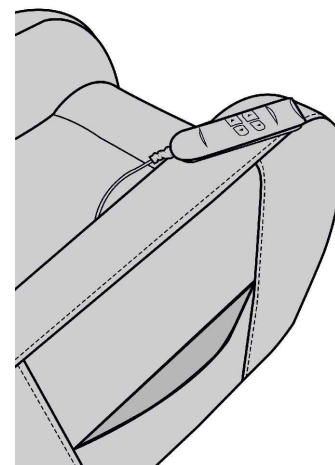
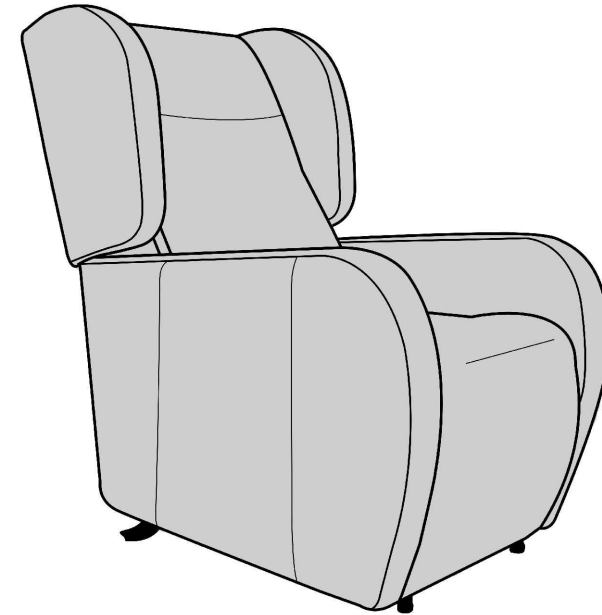

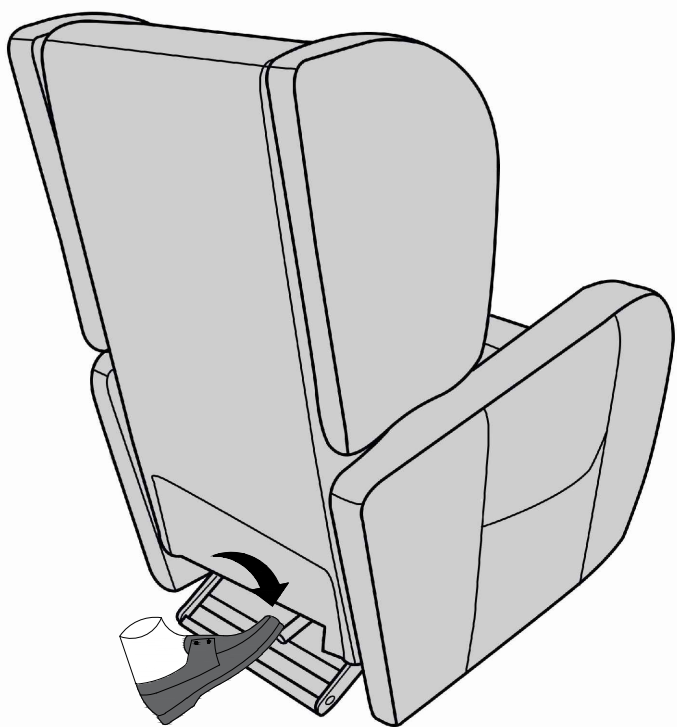

Позиция на лостовата система, при използване на движещия механизъм (ролер борд).

Position du système de levier lorsque le mécanisme d'entraînement (planche à roulettes) est utilisé.

Position of the lever system, using the moving mechanism (roller board).



Връщане на лоста, когато не се използва системата ролер борд.

Renvoyez le levier, lorsque vous n'utilisez pas le système de planche à roulettes.

Return the lever, when not using the system Roller board.

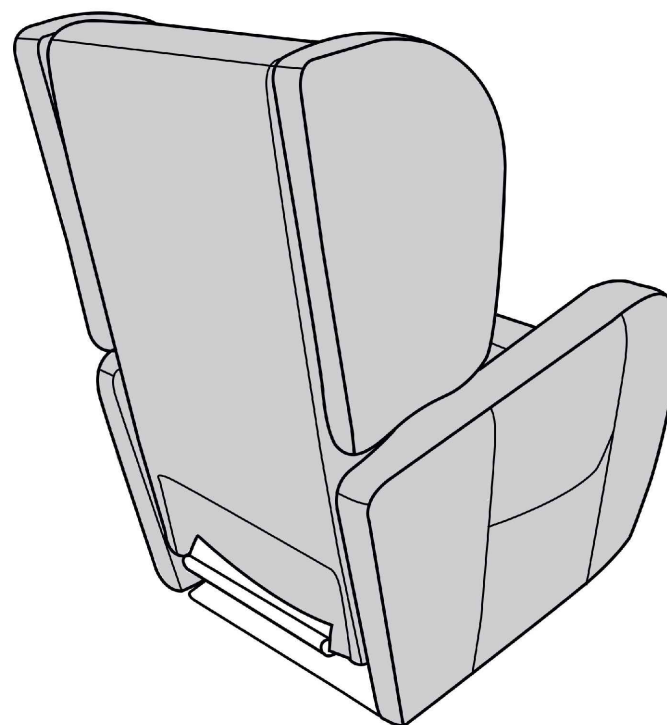
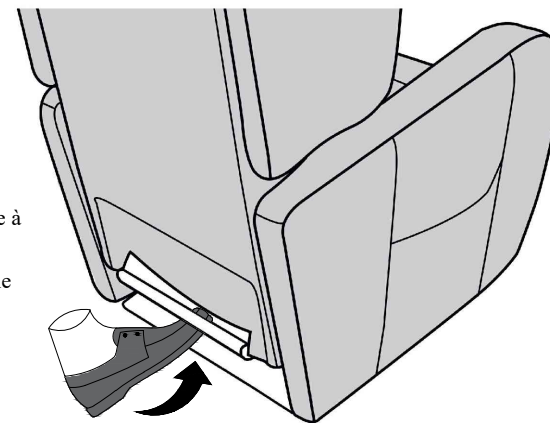

Задвижване на релакс и лифт системата.

Propulsion du système relax et lift.

Propulsion of the relax and lift system.

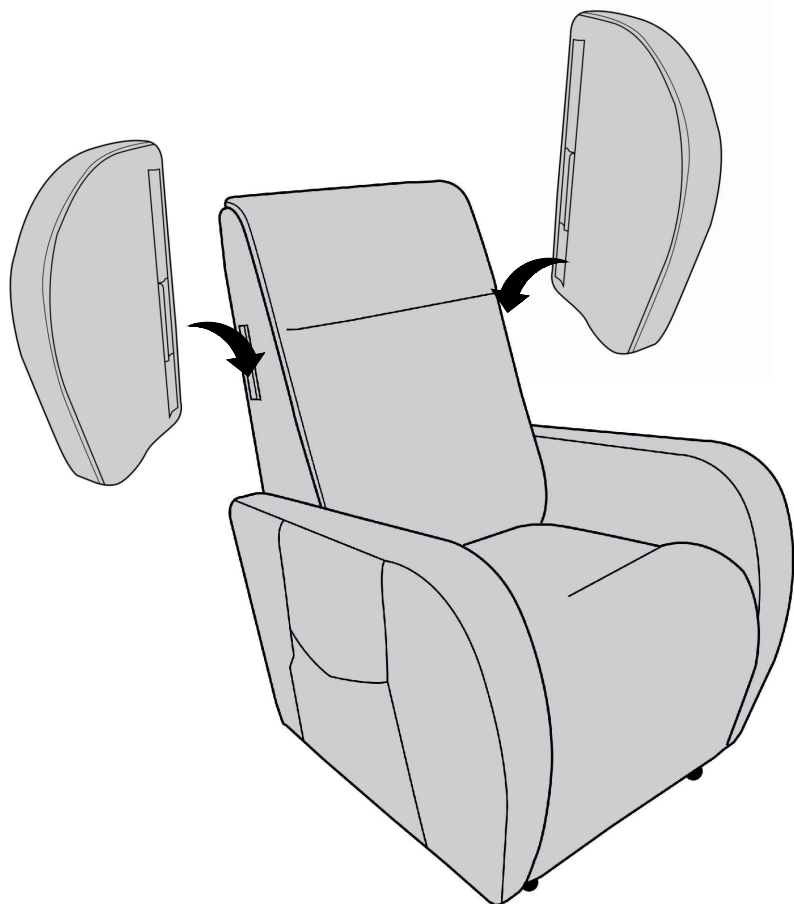

Закрепване на страничните облегалки, посредством плъзгащите планки, съгласно схемата.

Fixez les dos latéral à l'aide des plaques de connexion, conformément au schéma.

Attach the side backrests using the connecting plates, according to the scheme.

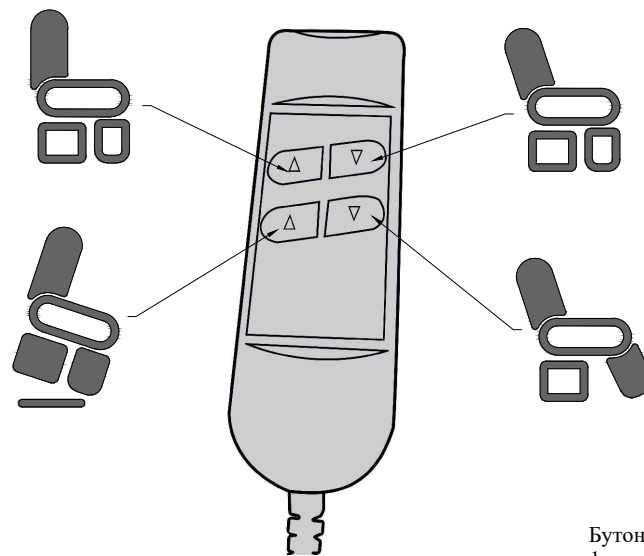
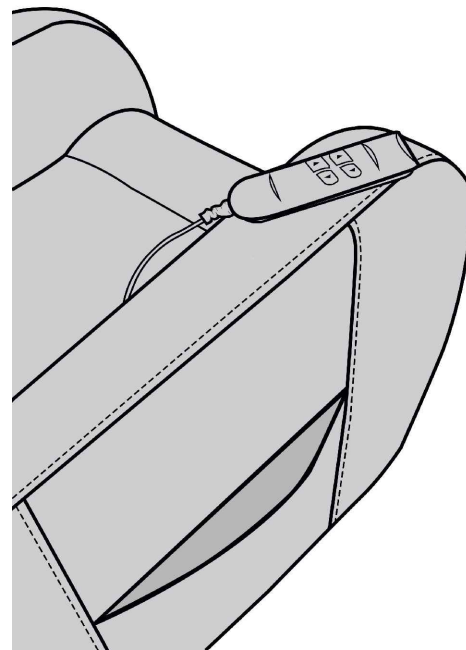

Бутони за управление на различните функции.

Boutons pour contrôler diverses fonctions.

Buttons to control various functions.

INSTALLATION OF ELECTRICAL COMPONENTS (APPLIES TO UNITS EQUIPPED WITH ELECTRICAL GEAR)

WARNING! Always ensure that cables run clear of the path of moving parts. Do not allow the cable to get caught the metal base.

WARNING! Do not connect to the power grid if any of the components appear damaged.

1. A connecting cable and an electrical adapter are provided to power the electrical function.

2. Connect the adapter to the electrical gear of the unit using the cable connection. Lock the cable connection as indicated.

3. Plug the connecting cable into the electrical adapter.

4. Plug the other end of the connecting cable into the power supply with a voltage of AC100-240V.

